



swiss lifting solutions

INSTRUCTIONS CONFIGURATION OF GISKB RAW PROFILES



since
1957

www.gis-ag.ch

GISKB I + II RAW PROFILES

GISKB light crane systems are perfectly suited for low lifting capacities and quick assembly. The special GISKB I and II cold-rolled profiles are made of high-quality steel.

The 8'010 mm long GISKB raw profiles form the basis for further processing. After cutting the hollow profiles to length, the end plates have to be welded on accurately with the help of the welding gauge. Afterwards, the profile has to be degreased, followed by a primer and/or a RAL coat.

In addition to the straight profiles, bends of 30° and 45° may also be purchased in raw state.

GISKB I + II raw

Material description:
Cold-rolled raw steel profile in excess length.
Supplied in particular bundle size.
Dimensioning of profile sizes to be referred to our technical documentation.

Article number for
GIS profile raw (8 m)
GISKB I GISKBII
9305.1000.B 9306.1000.B

Welding gauge

The profiles are cut to length. The welding gauge has to be screwed to the end of the profile first, followed by welding the end plate on. Remove the welding gauge and repeat the same on the other end of the profile.

Article number for
End plate raw
GISKB I GISKB II
9305.1001.4 9306.1001.4

Article number for
Welding gauge
GISKB I GISKB II
V9934.5200.3 V9934.5201.3



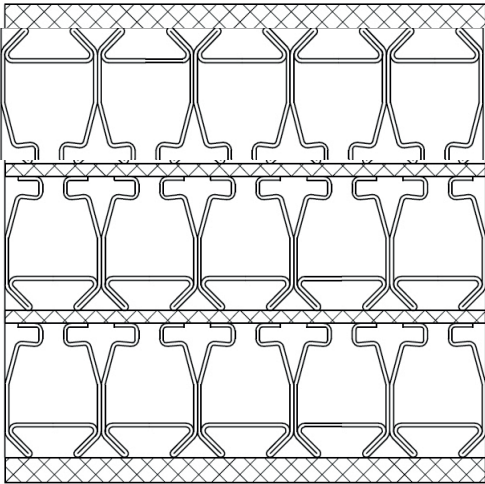

Raw profiles GISKB I

Packaging indications

3 layers with 5 GISKB I profiles each layer; total 15 profiles

Measurements: Length x Width x Height
8'010mm x 380mm x 400mm

Weight: Gross 1'160 kg

Protected by 8 IPPC woods

Strapped several times with 19 mm PET-STRAP

Top layer reversed

Stackable

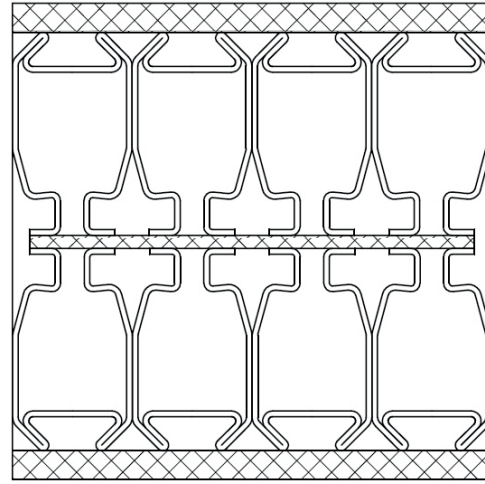

Raw profiles GISKB II

Packaging indications

2 layers with 4 GISKB II profiles each layer; total 8 profiles

Measurements: Length x Width x Height
8'010mm x 340mm x 350mm

Weight: Gross 960 kg

Protected by 8 IPPC woods

Strapped several times with 19 mm PET-STRAP

Layers facing each other

Stackable



GISKB III + IV RAW PROFILES

Our GISKB III and IV hollow profiles are perfectly suited for higher loads and wider spans. The two-piece cold-rolled special profiles are made of high-quality steel.

Due to the profile length of 12 m, a special lorry is needed for the transport. The hollow profile is cut to the required length. With the special welding gauge, three connecting sleeves are welded on precisely. Afterwards, the profile has to be degreased followed by a primer and/or a RAL coat.

GIS III+ IV raw

Material description:

Two-piece cold-rolled raw steel profile without excess length. Supplied in particular bundle size.

Dimensioning of profile sizes to be referred to our technical documentation.

Article number for

GIS profile raw (12 m)

GISKB III	GISKB IV
9307.1000.B	9307.1001.B

Welding gauge

In order to prepare the profiles for the particular length, the end plates have to be welded on in raw state.

We have a welding gauge for each GISKB size.

Article number for

Connecting sleeves

(3 pcs each end of profile)	
GISKB III	GISKB IV
9307.1061.4	9307.1061.4

Article number for

Welding gauge

GISKB III	GISKB IV
V9934.5111.3	V9934.5112.3

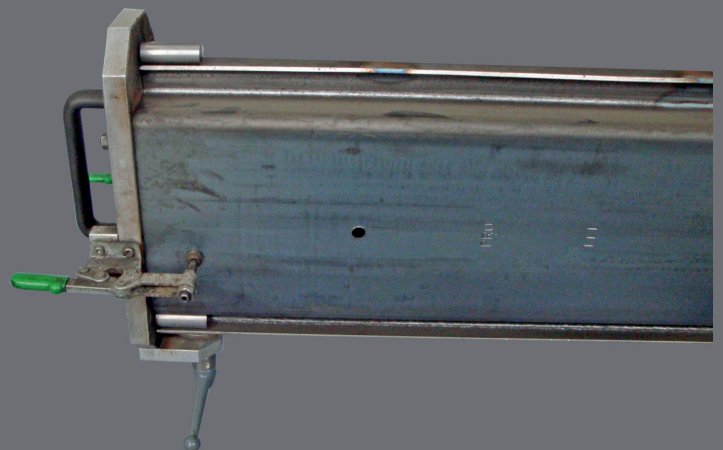

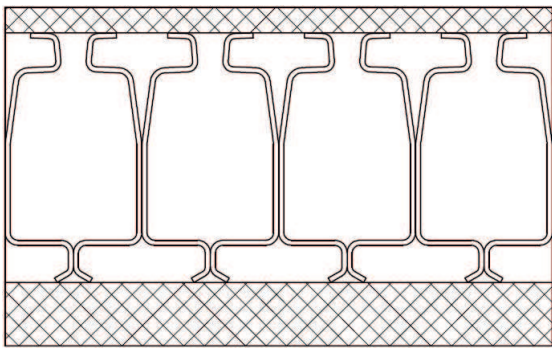

Raw profiles GISKB III

Packaging indications

1 layer with 4 GISKB III profiles

Measurements: Length x Width x Height
12'000mm x 440mm x 320mm

Weight: Gross 905 kg

Protected by 6 woods

Strapped several times with 19 mm steel strapping

Stackable

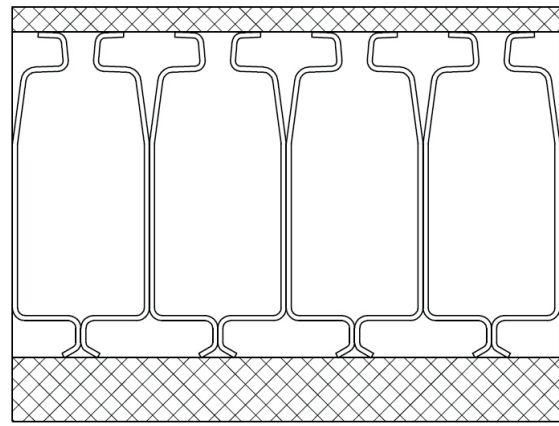

Raw profiles GISKB IV

Packaging indications

1 layer with 4 GISKB IV profiles

Measurements: Length x Width x Height
12'000mm x 440mm x 330mm

Weight: Gross 1'090 kg

Protected by 6 IPPC woods

Strapped several times with 19 mm PET-STRAP

Stackable

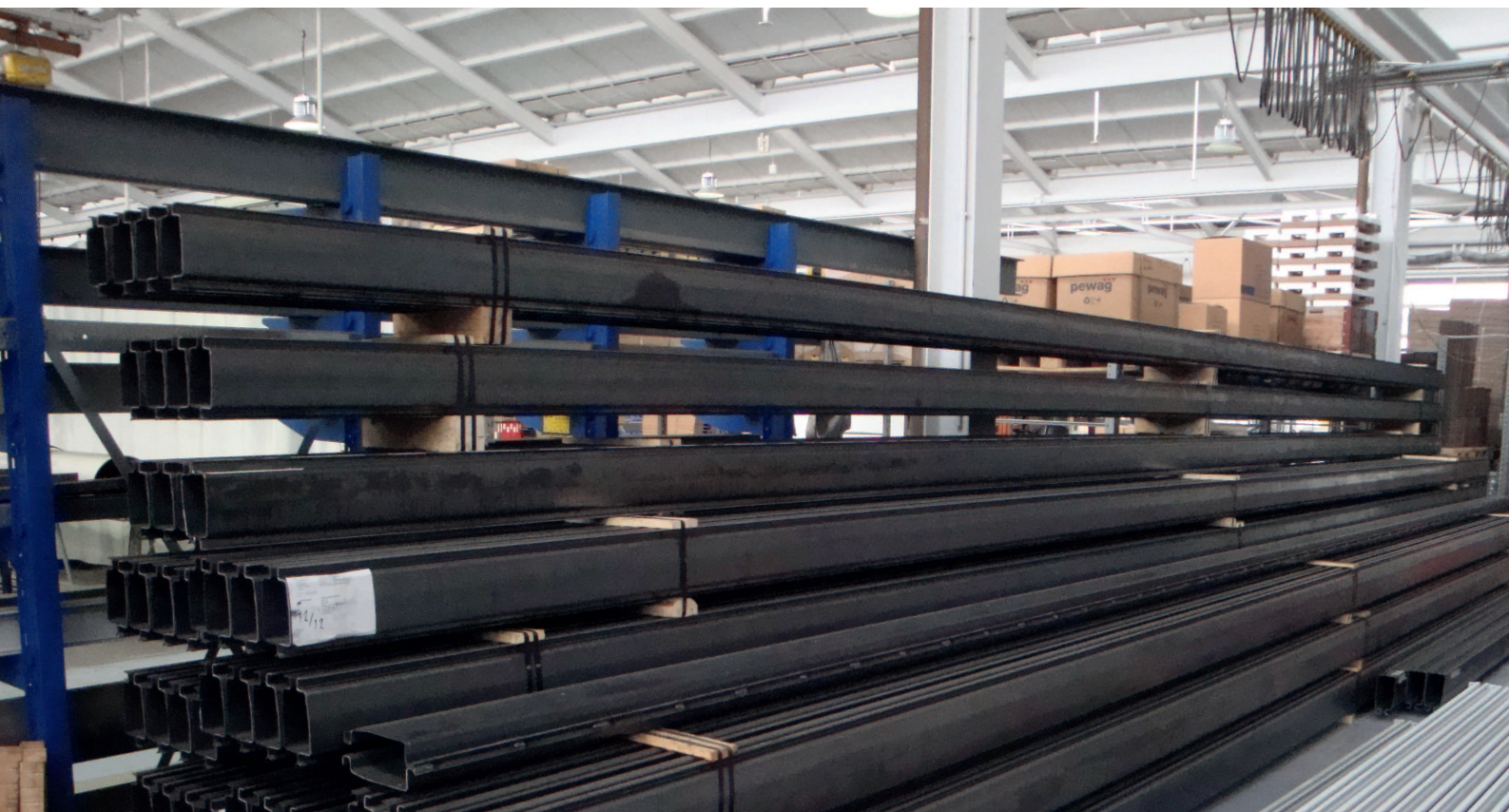

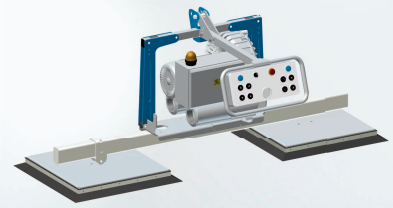
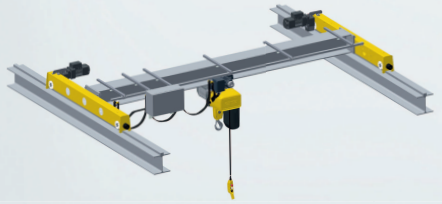

Crane systems

GISKB steel crane construction kit for line-bound or all-round goods handling. GISKB aluminium crane system, slewing pillar and wall cranes for smooth handling of transport goods. Travelling cranes and slewing cranes made of steel profiles for heavier loads.

Hoisting equipment

Over 50 years experience in the manufacture of electric chain hoists: robust, durable, reliable and highly resistant to wear. Simple maintenance. Various special versions for every application area. Wide range of accessories and options.

Vacuum handling systems

GIS vacuum handling systems for the ergonomic and gentle handling of goods made of different materials like wood, glass, stone, metal or plastic. In combination with the appropriate crane system.

GIS AG – the specialist for crane systems Founding of the GIS AG in 1957 | With own subsidiary in Germany since 1966 | Development and production of electric chain hoists in Switzerland for over 50 years | Swiss manufacturer of complete crane systems inc. hoisting equipment and vacuum lifters | Certified to ISO 9001 since 1994 | Complete market services from project planning to installation, start-up and maintenance | International sales network with over 50 qualified partners worldwide

Swiss Lifting Solutions

Certified to ISO 9001